

ConsiderIt: Accessible

Framing Deliberation in the Blind and Low-Vision Community

Designing for Accessibility

- ConsiderIt is a platform that helps individuals **deliberate on complex civic issues**
- The existing UI was incompatible with screen readers or mobile devices
- We designed an **alternate view** for **mobile devices** and **screen readers**
- We launched the Metro Proposal Guide as a pilot application to assess our design

Use Scenario

Anne hears about the Metro Proposal Guide, a site for discussing Metro Transit's accessibility policies.

1 On the homepage, Anne sees a list of hypothetical proposed policy changes.

Original Site

Before: wide, spatial layout
After: single-column vertical flow

Before: reveal/hide content with JavaScript
After: static page content

Before: custom interaction widgets
After: standard HTML links and buttons

Before: all-in-one page
After: small pages with uniform layout

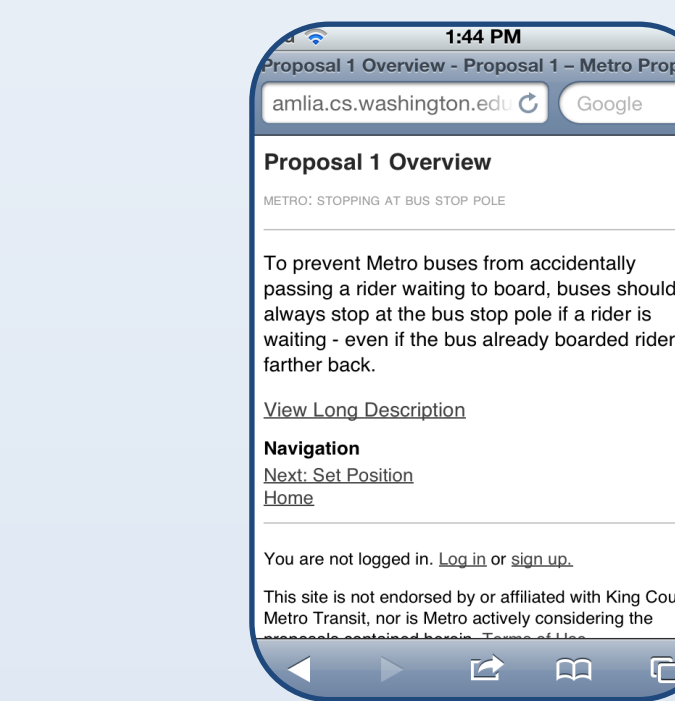
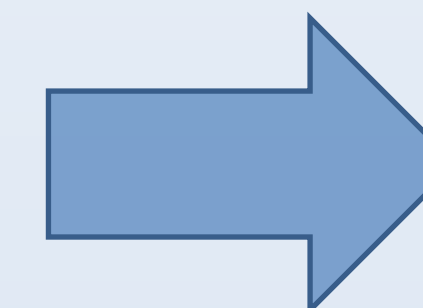

2 Anne selects a proposal to discuss.



3 Anne records her initial opinion of the proposal. Next, she can consider pros and cons.

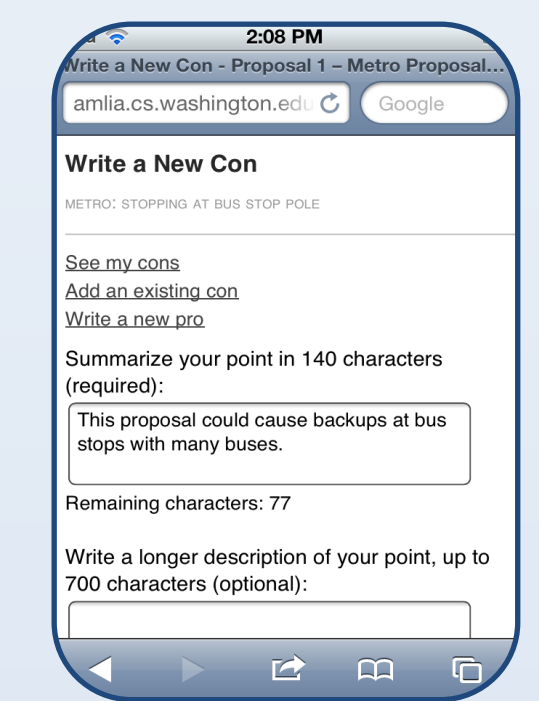
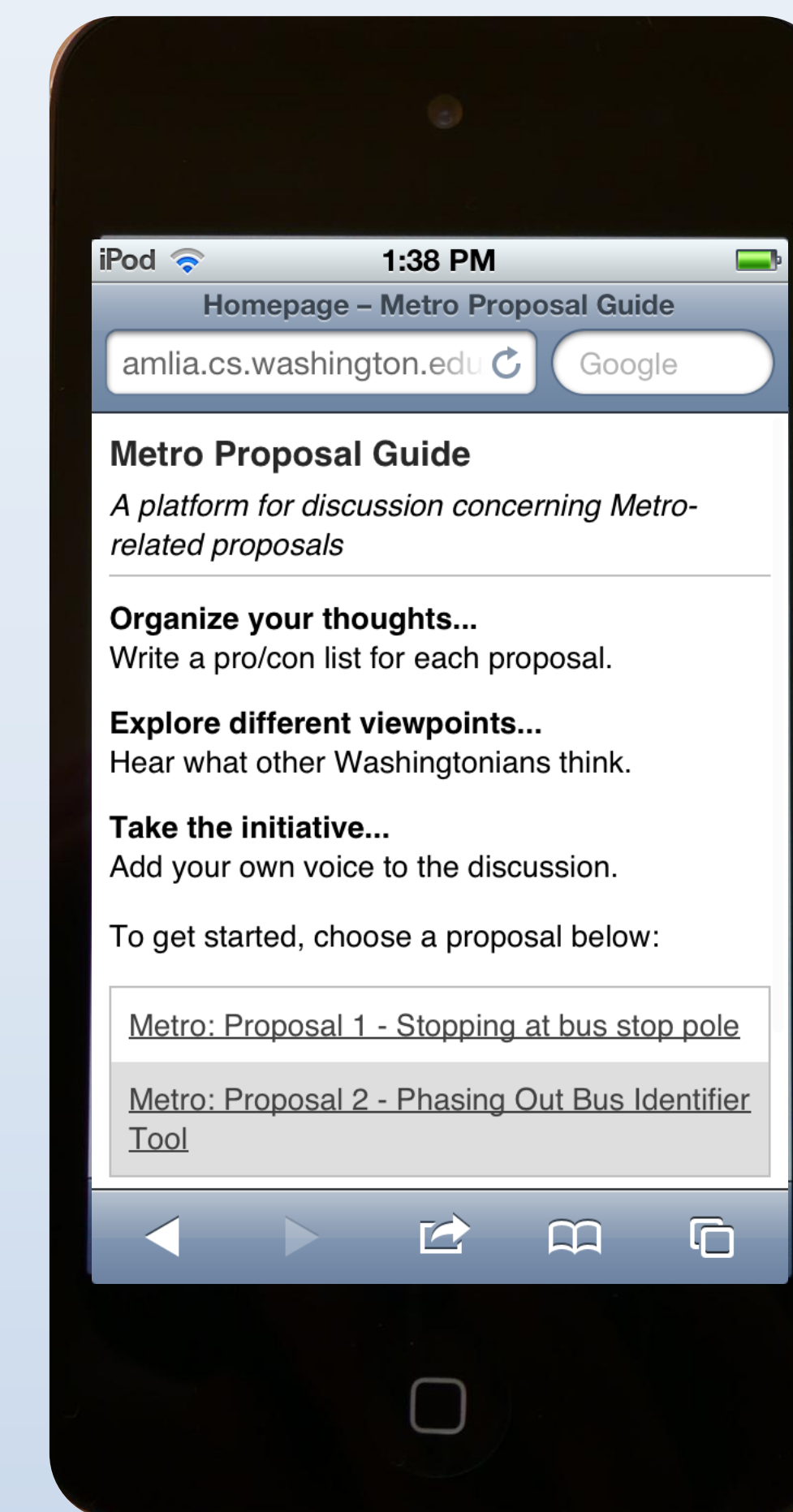

6 Anne also reads the cons and contributes a new con for discussion.

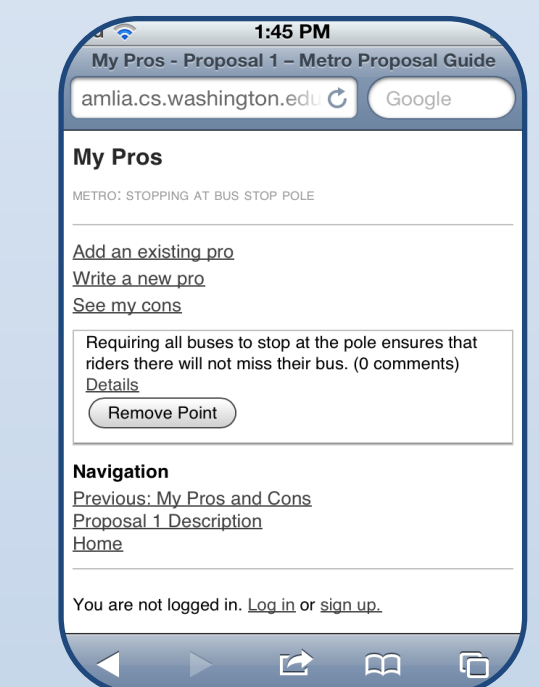

5 Anne adds the pro to her personal list of pros.

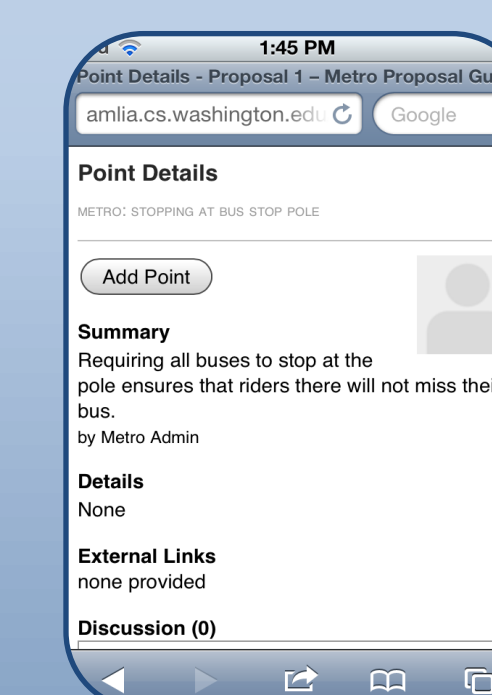

4 Anne scans the pros other users have written and views the details of one pro.

Try it out!
<http://amliia.cs.washington.edu>

Future Work

- Continue to evaluate **usability** of design
- Collect **metrics** and conduct **user interviews** on Metro Proposal Guide
- **Integrate** into existing Living Voters Guide application

Acknowledgments

- Many thanks go to:
- Deb Cook, our mentor
 - Travis Kriplean
 - Alan Borning and Shiri Azenkot

