

Assignment 3e: Digital Mockup

CSE 440 Section AB | DASH

Digital Mockup Overview

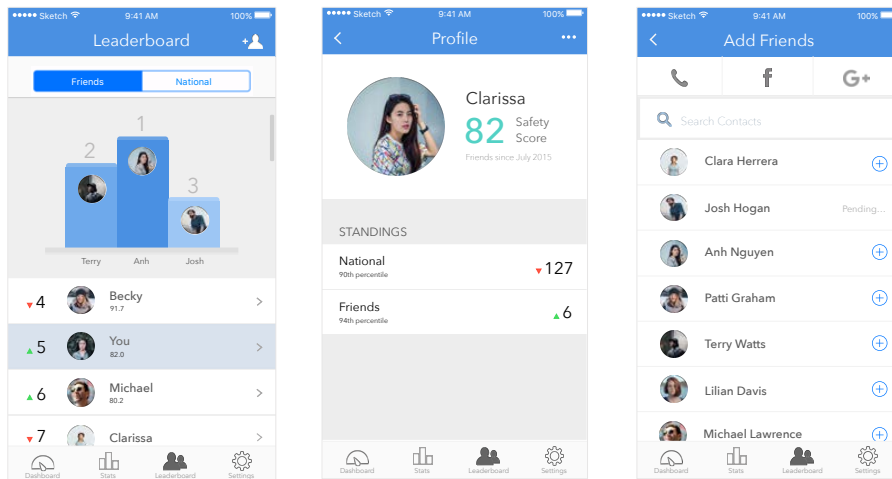
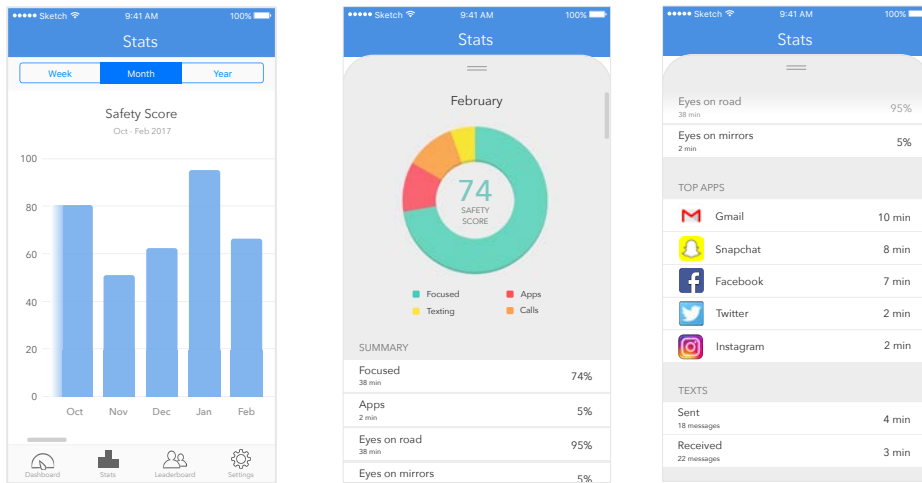
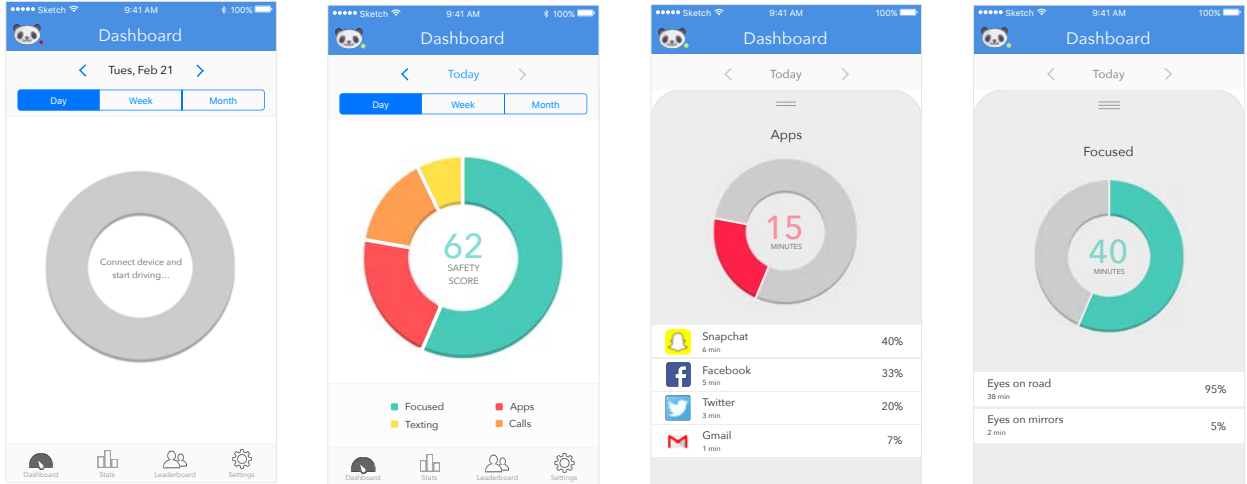

Digital Mockup Overview

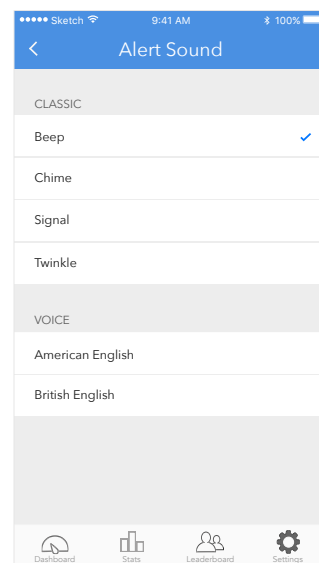
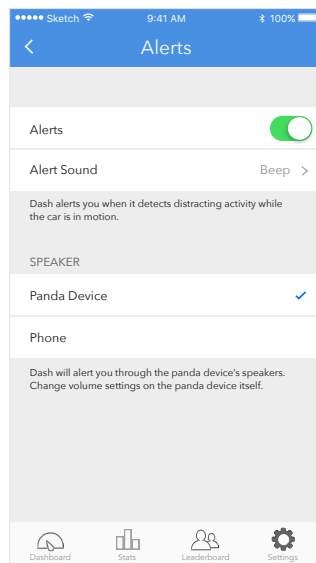
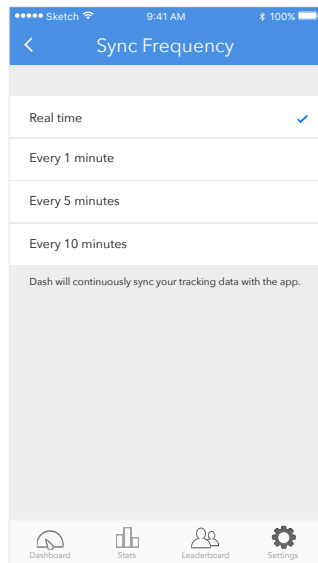
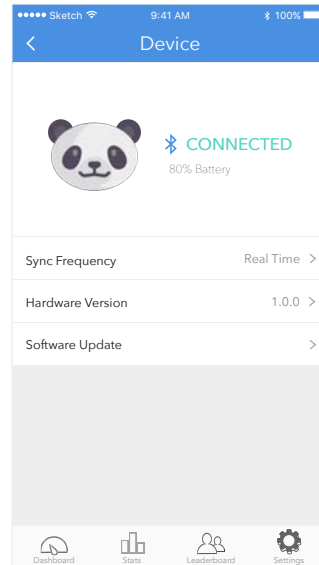
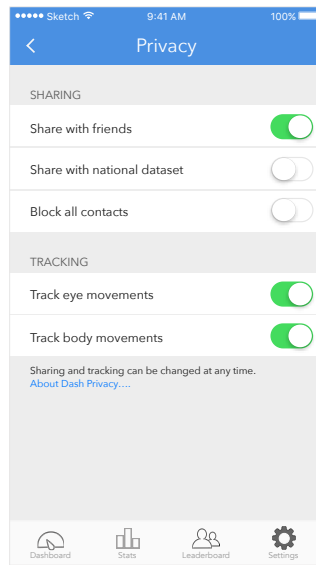
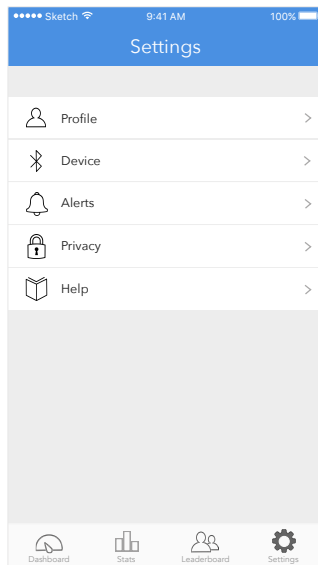

Task 1: Visualizing and Processing Driving Behavior

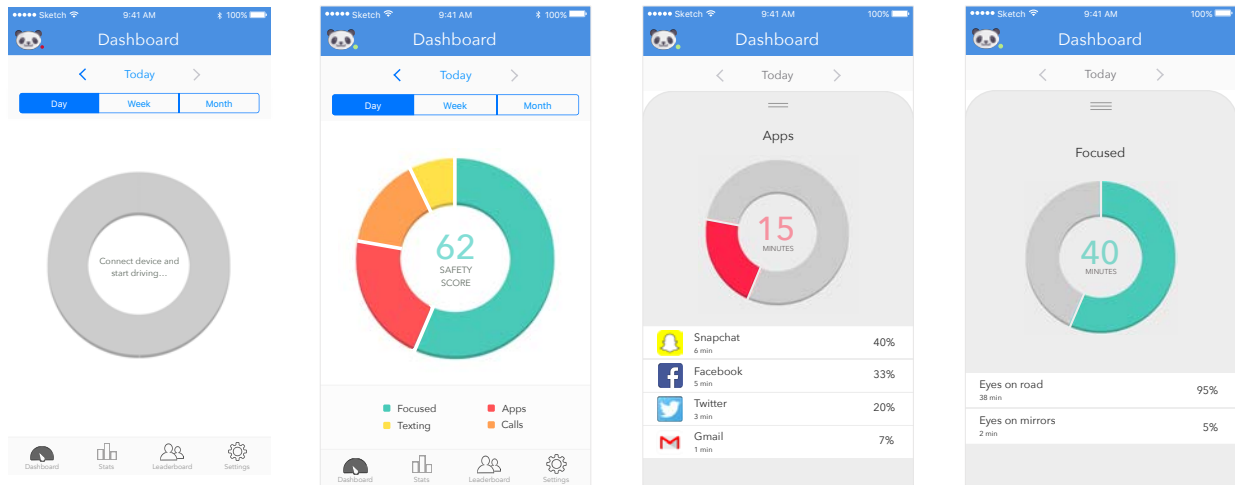

These screens are found on the Dashboard tab of the app. The first screen will appear if the driver has not driven during the current day and/or their panda tracking hardware is not paired (upper left panda graphic has a connection indicator light). Upon driving, the dashboard will be populated with an interactive graph. The driver will be taken to a detail view if he/she clicks on any section in the pie chart; information is provided on duration of activity.

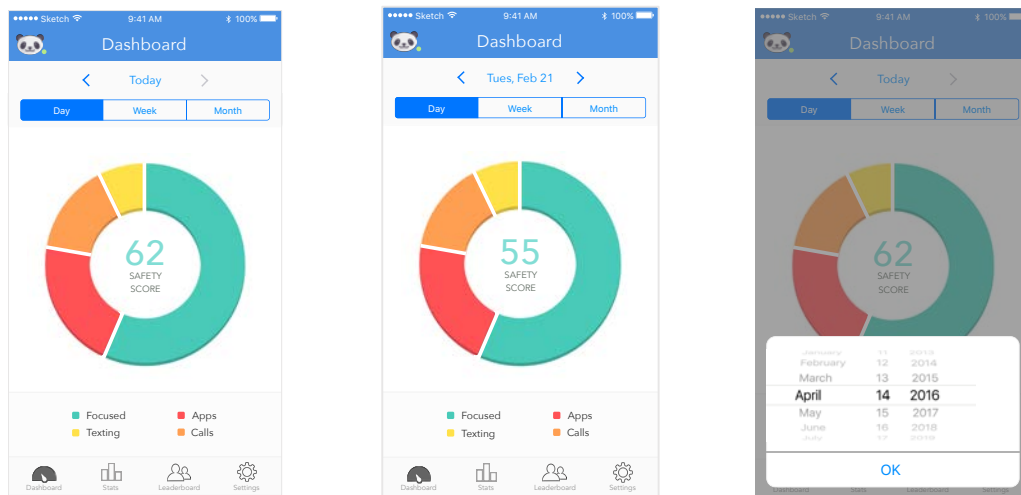

These screens demonstrate the app's ability to show different dates of driving data. Clicking on "Today" (or whatever is the date at the top of the screen) will allow the driver to select a date. Clicking on the left and right arrows leads to different days/weeks/months, depending on the current selection below.

Task 1: Visualizing and Processing Driving Behavior (cont.)



These screens are part of the Stats tab of the app. The graphs are interactive, so scrolling left and right will display data for different weeks/months/years depending on the selected date type. Clicking on a bar will lead to a detail view, which includes a percentage breakdown of activities, list of top apps, texts, and more.

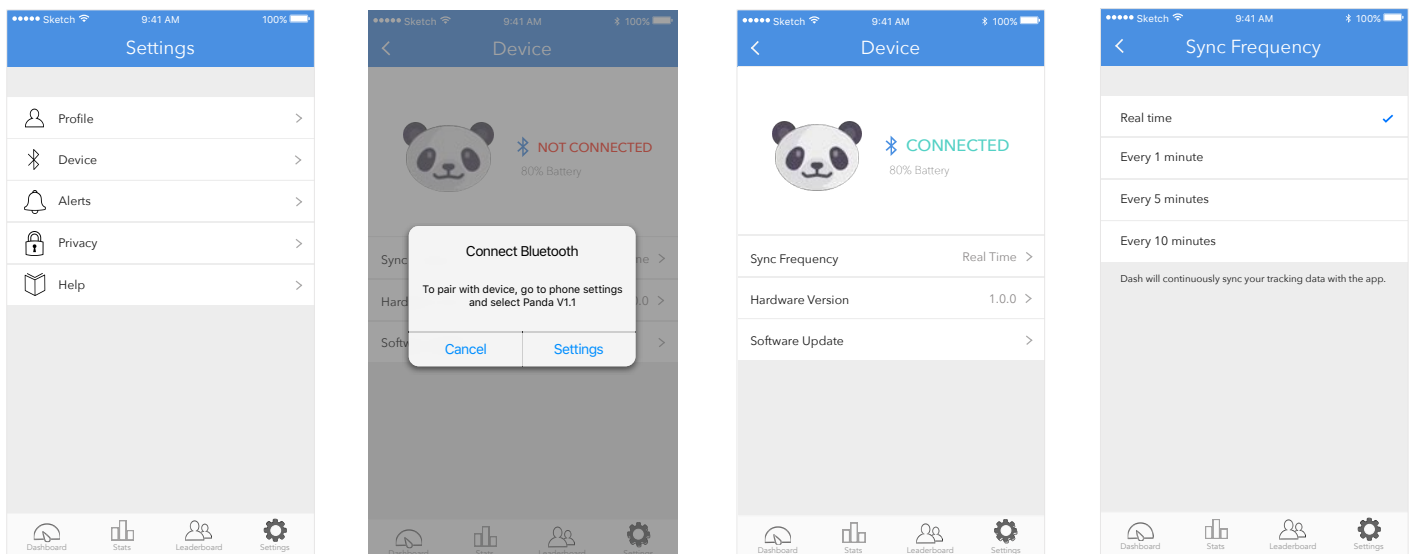

Device settings can be adjusted from the Settings tab of the mobile app. Upon entering the "Device" page, if the app does not detect a paired device, it will prompt the user. The third screen displays a connected device. Finally, the driver can choose the sync frequency between the hardware and app (defaults to real-time tracking).

Task 2: Comparing and Sharing Driving Habits

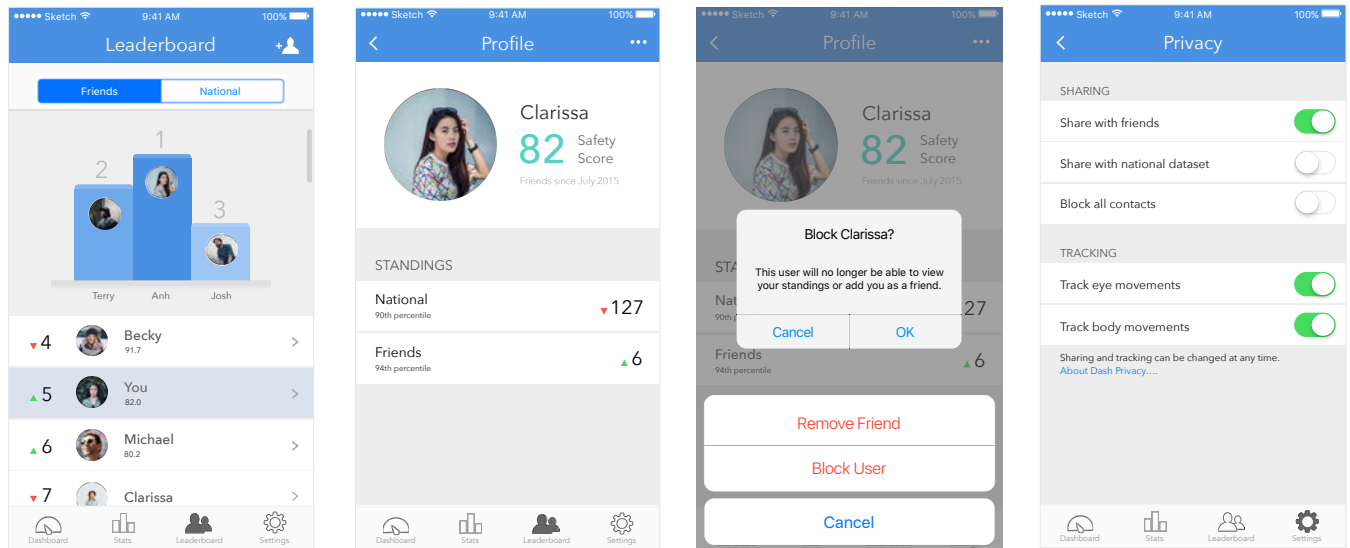

The Leaderboard tab allows drivers to accomplish Task 2. Users have the choice to compare their standings with contacts or with a national dataset. Clicking on anyone on the leaderboard list leads to their profile, which lists their safety score standings. Triangles pointing up indicate a user has increased in standing in the past day (and otherwise for a triangle pointing down). Friends can be removed or blocked anytime via the ellipsis button in the upper right hand corner of the second screen. Users can update sharing and tracking settings anytime in the Settings > Privacy page.

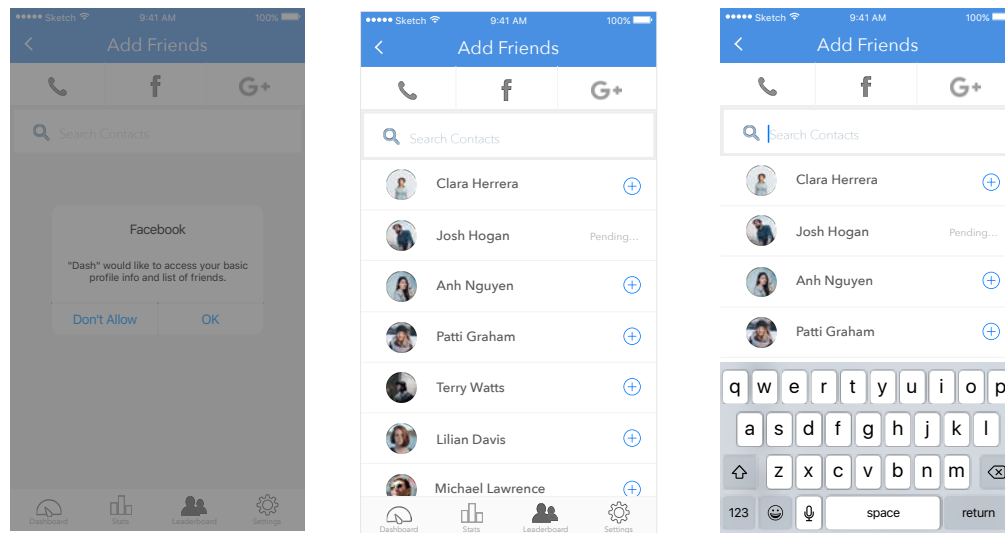

Adding contacts is essential to sharing information with friends. The Add Friends view is accessed by the upper right hand icon in the Leaderboard tab. Drivers can add friends from their phone contact list, Facebook, or Google+, which they specially allow Dash to access. Finally, friends are searchable by name as shown in the last screen.

Decisions and Changes

Many small cosmetic and documentation changes were added to the design. For example, in many of the settings screens, there are sentences below setting titles that explain the current state of the system. These helpful hints were inspired by Apple's current Settings pages.

In the Dashboard view we included two visual elements to the screen: a legend for the pie chart and an iOS date picker for choosing time frames. We included these elements for readability and ease-of-use. To remain consistent with our Statistics detail view, we made the Dashboard detail view a pull-down frame as well.

In the Leaderboard view, we upgraded the Add Friends function to a page on its own (previously, we only had a pop up window appear). Before, we only supported a design for phone contacts, but with the popularity of social media platforms such as Facebook and Google+, we decided to add these options as well.